

Dublin TCE Superfund Site Update

December 2025 | Dublin Borough, PA



Upcoming Work in Your Neighborhood

To address the contaminated groundwater impacted by the Dublin TCE Superfund site, a groundwater extraction and treatment system is being installed in your neighborhood.

The work began in November 2025 and will continue off and on through spring 2026. During active construction, the area near 120 Meyers Way will be temporarily closed to through traffic. Businesses and residences along Meyers Way will be accessible through the detour.

You may notice increased construction vehicles and intermittent road closures. To minimize impacts on the community, blockades will be removed when the detour is not in effect. Once construction is complete, the entire road will be repaved.

What is the Dublin TCE Superfund site?

The **Dublin TCE Superfund site** is located in Dublin Borough, Pennsylvania. In 1986, the Bucks County Health Department found trichloroethylene (TCE) in the tap water of 23 homes in Dublin. TCE is a volatile chemical solvent that was commonly used for industrial cleaning and degreasing. The highest levels of TCE were found on a property where several manufacturing businesses operated over the last 50 years. Historic dumping is believed to be the main source of TCE contamination in the groundwater. The site was added to the U.S. Environmental Protection Agency's Superfund National Priorities List in August 1990.



Construction equipment staged at 120 Meyers Way.

Private drinking water wells affected by the site are no longer in use for consumption. Treated drinking water is now provided by Dublin Borough and meets federal *Safe Drinking Water Act* standards.

THE SUPERFUND REMEDIAL PROCESS

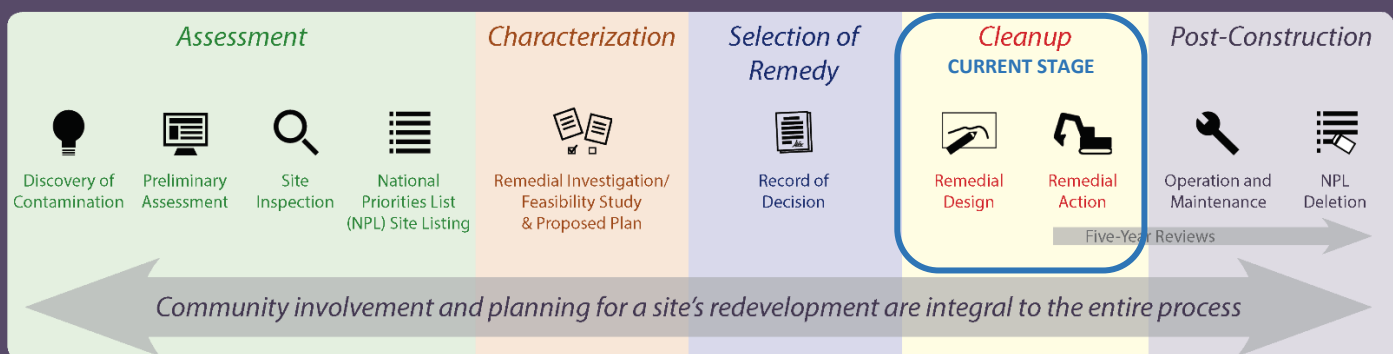

Remedial Action/Construction Update

- In November 2025, potentially responsible parties began construction of the groundwater extraction and treatment system.
- The project is expected to be completed in spring 2026.
- Work includes installing a treatment system to collect and filter contaminated groundwater, as well as pipes to transport the treated groundwater to a nearby storm sewer.
- Treated groundwater will be monitored by the Pennsylvania Department of Environmental Protection and discharged to a local waterway.

What happens after construction?

- Contractors will operate and maintain the groundwater extraction and treatment system.
- Ongoing groundwater monitoring will ensure that the extraction and treatment system are effectively preventing the spread of contamination and restoring the groundwater quality to protect human health and the environment.



Construction crew trenching on Meyers Way to lay the conveyance piping for the treatment system.

Overview of a Groundwater Extraction and Treatment System

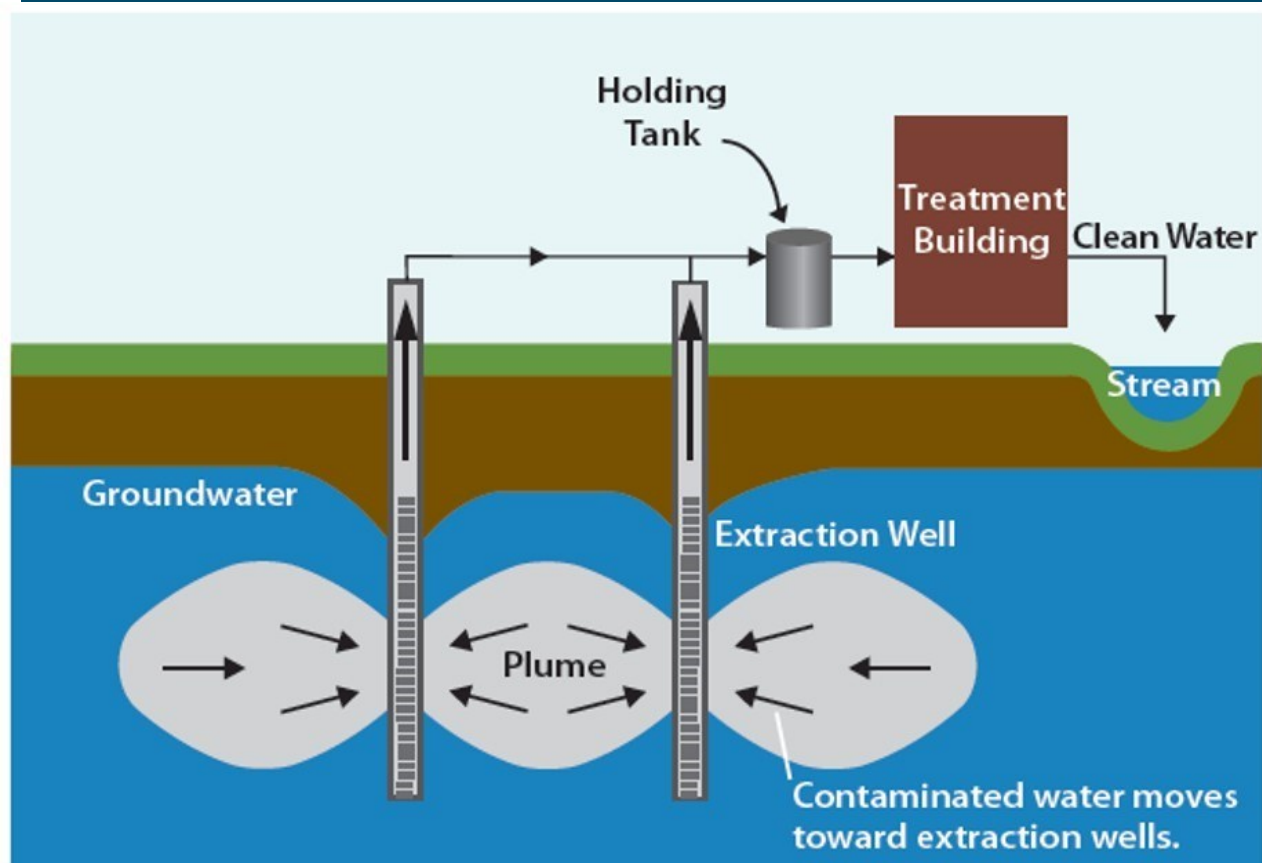

What is Trichloroethylene (TCE)?

TCE is a contaminant of concern (COC) at the Dublin TCE Superfund site. COCs are chemicals that need to be addressed by a cleanup action because they are a potential threat to human health or the environment. TCE is a volatile organic compound, or VOC. This kind of organic chemical compound evaporates under normal indoor temperatures and pressure. TCE is part of many industrial and commercial processes, including in dry cleaning facilities and manufacturing processes. Short term exposure to TCE may cause neurological effects such as dizziness and poor coordination. Prolonged exposure is linked to increased cancer risk. It is one of the most common contaminants at Superfund sites.

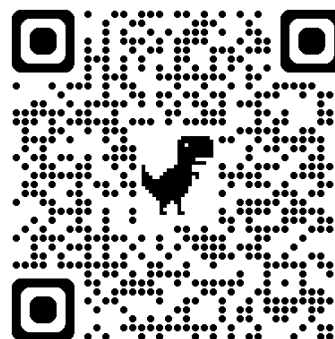
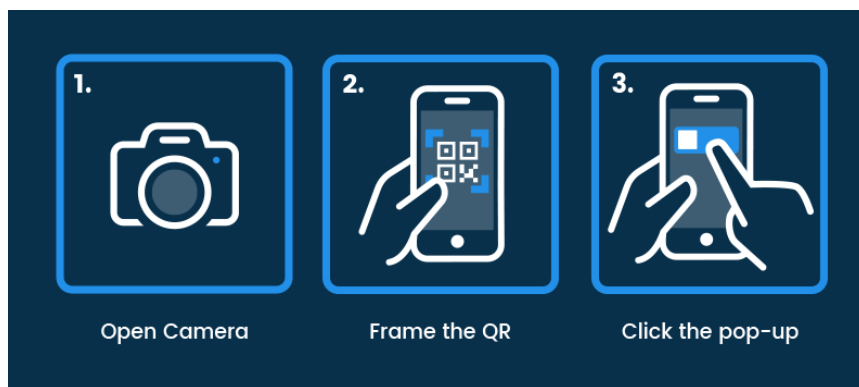

Is My Drinking Water Safe?

Dublin Borough operates treatment systems and provides water to its customers that meets all state and federal drinking water standards for regulated contaminants. For more information on drinking water quality testing results, please visit www.dublinborough.org

or contact Dublin Borough at
215-249-3310

To learn more about this site, visit:

www.epa.gov/superfund/dublin

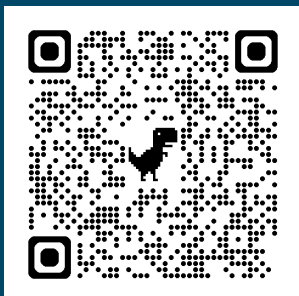

Questions? Contact us!

Tom Smith, Remedial Project Manager
U.S. Environmental Protection Agency, Region 3
215-814-5718 • smith.thomas@epa.gov

Lisa Trakis, Community Involvement Coordinator
U.S. Environmental Protection Agency, Region 3
215-814-5433 • trakis.lisa@epa.gov